

ELEVATION

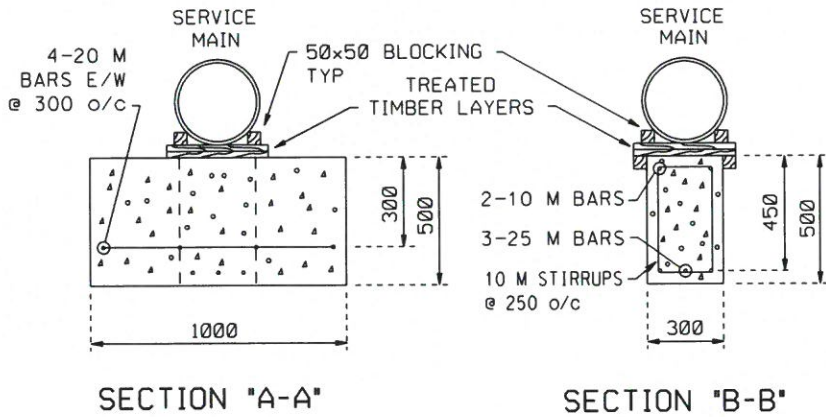

- NOTES:
1. ALL DIMENSIONS ARE IN MILLIMETRES UNLESS OTHERWISE SPECIFIED.
 2. ALL CONCRETE TO BE 20 MP_a, REBAR TO BE 300 MP_a.
 3. CLEAR COVER ON ALL REINFORCING STEEL TO BE 50 mm.
 4. ALL CONCRETE HIGH EARLY STRENGTH, SULPHATE RESISTANT.
 5. ALL STRUCTURAL STEEL TO BE GALVANIZED.
 6. ALL REBAR SPLICES TO BE 800 mm MINIMUM.
 7. CONCRETE INSERTS TO BE INSTALLED AS PER MANUFACTURER'S GUIDELINES.

20170215 10:24 cawright 2514-10.DGN

	100mm TO 300mm WATER SERVICE FOR UNSUITABLE FOUNDATION CONDITION (BUILDING ABUTTING PROPERTY LINE)			DRAWING NUMBER
	APPROVED MARCH 2017	DRAWN BY Dale Vandenberg	APPROVED 	2514-10
SCALE N T S	CHECKED BY Doug S.	DIRECTOR, WATER DISTRIBUTION AND TRANSMISSION	REVISION 0	